

GEDA 300Z

Features & benefits

The GEDA 300Z is a compact and robust hoist lifting up to 300kg of goods on-site.

The hoist can be fitted with a scaffold/sheet frame to enable the safe lifting of scaffolding and sheet materials.

Once at the landing level, the cage can be swivelled by 90 degrees to the left allowing a safe loading and unloading.

The hoist is available in 240v or 415v versions to suit the power supply on-site.

- 240v or 415v electric options.
- Up to 100m in height (415v) or 50m (240v).
- Safe working load (SWL) 300kg.
- Hoisting speed 20m/min (240v), 30m/min (415v).
- Optional Load & Lock Scaffold Rack.
- Transported by trailer.
- Can be paired with our 10kva generator.



Towed to the site by trailer

Loading at the base



Swinging in platform

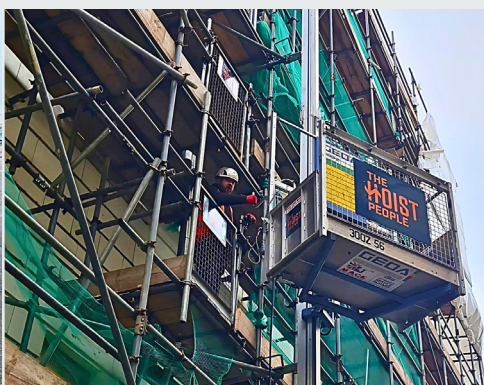

Hoist at the landing position



Power requirements

Dedicated 240v 16a Commando Socket.

Dedicated 415v 32a 5 Pin Commando Socket.

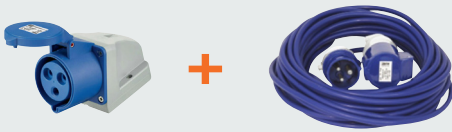

OR ...



16a Single Phase C Type MCB /
32a Three Phase C Type MCB.

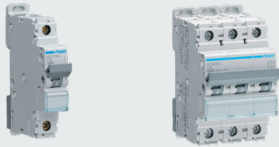

Can be paired with our 10kva generator



Must use 4mm heavy-duty leads with long runs due to volt drop on start-up currents.

	Geda 300z Single Phase 240v	Geda 300z Three Phase 415v
Maximum Height	50m	100m
Lifting Capacity - Goods Mode	300kg	300kg
Lifting Capacity - Personnel Mode	n/a	n/a
Lifting Speed - Goods Mode	20 m/min	30 m/min
Lifting Speed - Personnel Mode	n/a	n/a
Power Source	240v Electric	415v Electric
Breaker Rating	16a Single Phase C Type MCB	32a Three Phase C Type MCB
Power Requirements (Within 2m of the hoist base)	Dedicated 240v 16a Commando Socket	Dedicated 415v 32a 5 Pin Commando Socket
Start up Current (Max)	35a	45a
Running Current (Max)	7.7a	5.5a
Cage Dimensions (Internal)	W 800mm - L 1400mm	W 800mm - L 1400mm
Approx. Ground Space Required	2000mm x 2000mm	2000mm x 2000mm
Approx. Minimum Access Required	W 2100mm - H 3000mm - L 2400mm	
Approx. Gate Opening Dimentions	1200mm +	1200mm +

Platform size.

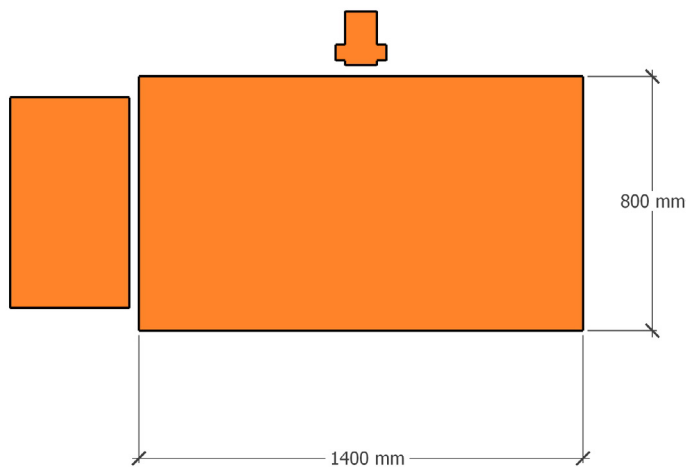

Tie spacing.

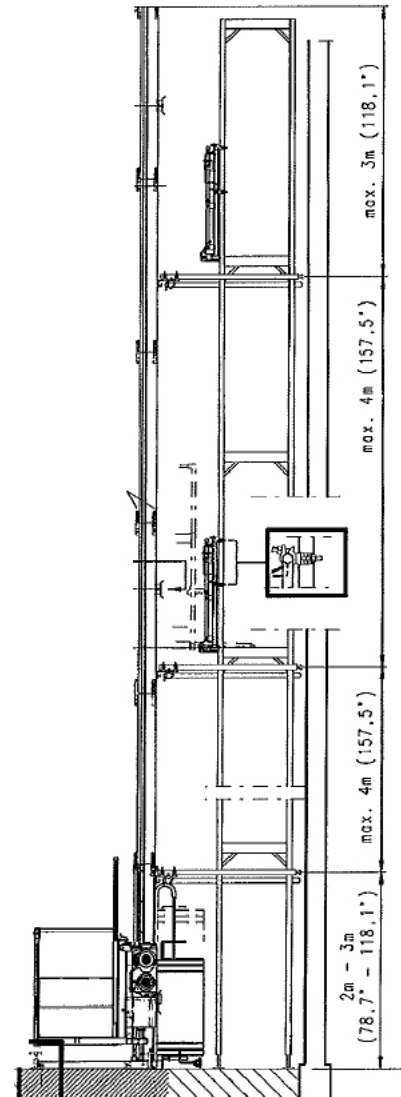

Scaffold installation.

